

## Dial type Float Level Gauge

Open or closed tanks.  
Limit switches as Microswitch or proximity switch.  
Potentiometric remote control.

Product group **748**

Type **212X**

Sheet: 1/1

Revision: 3

Date:

11/04

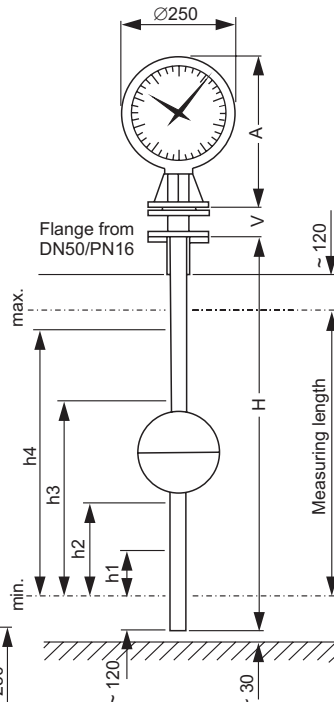

Float

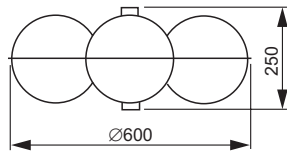

4K220/1-1,5

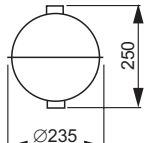

K220/1-1,5

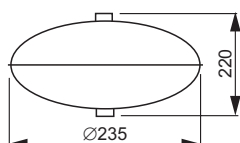

K300/1

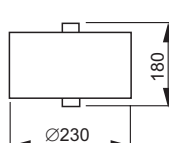

K225

Dimensions in mm

if EEx i then A=320  
if EEx d then A=410

### Field of application

This float level gauge Type 748.212X is for measuring liquid levels via a drag float and a wire which operates a mechanical mechanism. It is designed to work with a broad range of pressure and densities in zone 0, 1 and 2.

### General Data

Accuracy (in the range of 0...10 m): +0.1%  
Non-linearity/special: max. +0.5/0.3 %  
Measuring length max. SS/PP: 16 000/5 800 mm  
Mounting position: vertical  
Flange: DN50/PN 16

### Design Data

T Proc  
- normal version: -50...+150 °C  
- special version: -150...+350 °C  
PProc: max. 2.2 MPa  
Density: from 0,3 to 4 g/cm<sup>3</sup>  
Material  
- flange, guide pipe: SS  
- float: SS, PP  
- dial housing: cast Aluminium  
Ex-protection: II 2G EEx d IIB T6

### Electrical Data

**Micro switch**  
- Switch voltage: 250 V AC  
- Switch current: 2 A AC  
**Proximity switch**  
- power supply: 10...30 VDC  
- switch current: 100 mA  
- frequency: 3000 Hz  
- output: pnp/npn transistor  
**Analogue Output**  
- power supply: 230/24 VAC/24 VDC  
- output: 4...20 mA  
- burden: 50...500 Ω  
- Ex-protection: II 1G EEx ia IIB T4  
Ingress protection: IP 65

### Float table

| Type        | 4K220/1-1,5                  | K220/1-1,5                    | K300/1                        | K225                          |
|-------------|------------------------------|-------------------------------|-------------------------------|-------------------------------|
| Material    | SS                           | SS                            | SS                            | PP                            |
| Press. max. | 2.2 MPa                      | 2.2 MPa                       | 0.6 MPa                       | 1.0 MPa                       |
| Density     | 0.35...1.0 g/cm <sup>3</sup> | 0.92...1.64 g/cm <sup>3</sup> | 0.65...1.64 g/cm <sup>3</sup> | 0.92...1.64 g/cm <sup>3</sup> |

### Certificates

Transmitter: FTZU 02 ATEX 0226X  
Ex d housing: FTZU 02 ATEX 0139X

Subject to alterations

### Ordering no.

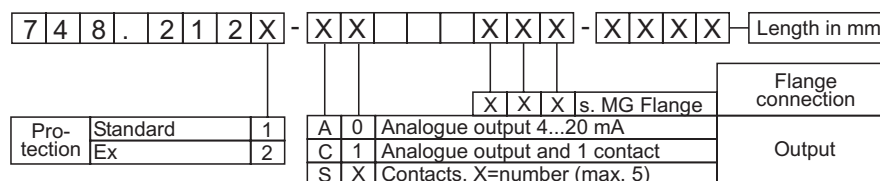

### PHÖNIX

Messtechnik GmbH  
Salzschlirfer Straße 13  
D-60386 Frankfurt/M.  
Tel. +49/69/41 67 42 -20  
Fax +49/69/41 67 42 - 29  
sales@phoenix-mt.com  
www.phoenix-mt.com